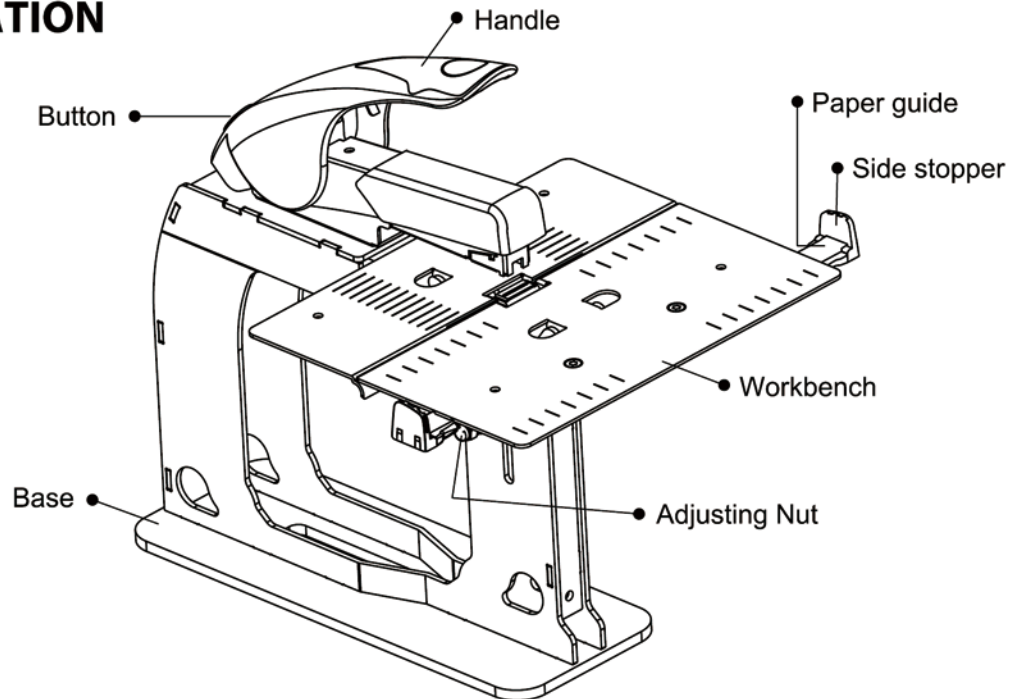

**058A3 SADDLE STAPLER****PARTS IDENTIFICATION****SPECIFICATIONS**

Paper Size	A3 , A4 & A5		
Capacity	20/40 sheets		
Paper Feed Depth	73mm		
Stapling Mode	Saddle and flat		
Staple Application	Staple	Leg Length	Sheets
	24/6(150 pcs)	6 mm	20
	26/6(210 pcs)	6 mm	20
	24/8(150 pcs)	8 mm	40
	26/8(210 pcs)	8 mm	40

**SAFETY INSTRUCTIONS**

1. The 058A3 Stapler must be used on a stable and solid table.
2. Keep the machine away from children and pets.
3. Keep loose clothing, jewelry and long hair away from all moving parts.
4. Read all instructions before attempting to operate the equipment.
5. Use this equipment only for its intended purpose.

**CAUTION**

Only 24/6, 26/6, 24/8 & 26/8 staples are suitable for this machine. Using other staples may cause damage to the machine. Unqualified staples will cause bad stapling quality or may result in the machine jamming and getting stuck.

# INSTRUCTIONS FOR USE

## Loading staples

1. Push the button backward.
2. Load staples.
3. Push the magazine back to the locked position.

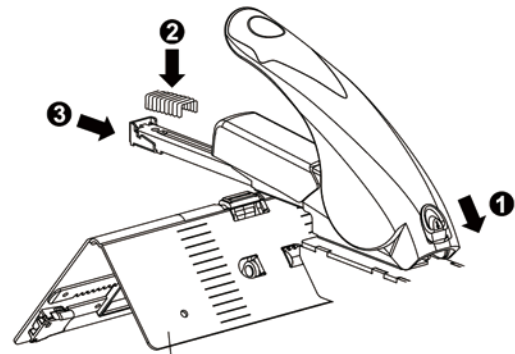

## Flat stapling & Saddle stapling mode

1. Push the adjustable nut & upward the workbench to Flat stapling mode.
2. Push the adjustable nut & downward the workbench to Saddle stapling mode.

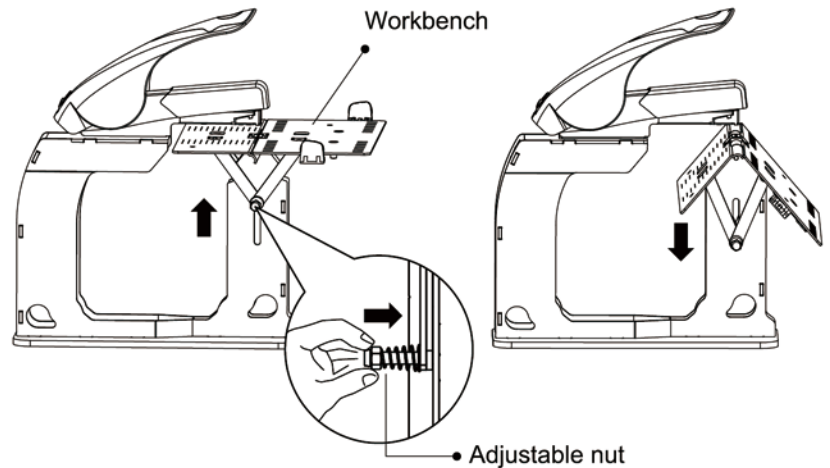

## Adjusting the paper position

### A. The side position

1. Pull the paper guide out and pull the side stopper up.
2. Adjust the paper on two sides if needed while stapling.
3. Paper guide can be folded if it's not in use.

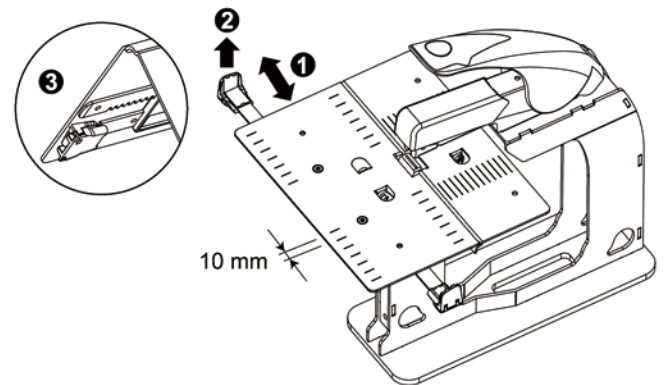

### B. Paper feed depth

Making sure the paper are flush by using the mark on the workbench to determine the feed depth.

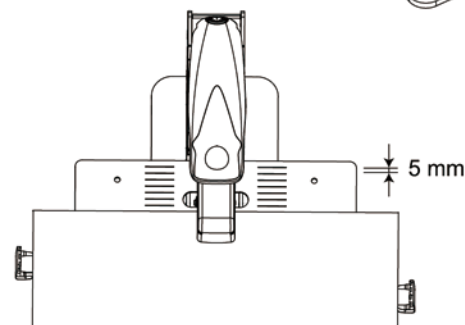

## Trouble shooting

### A. Removing the jammed staples

1. Place a pencil under the magazine.
2. Press the handle to eject the jammed staple.

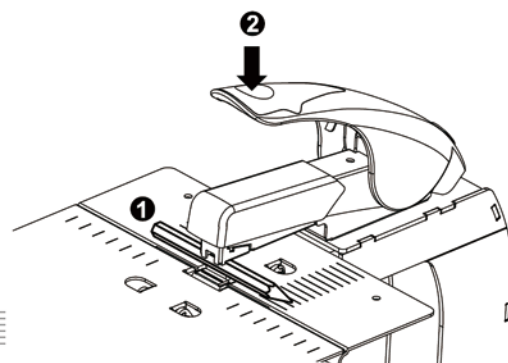

### B. Using proper staple



Staple too short



Staple too long



Correct staple